



SERVICE BULLETIN

NUMBER:	SB 500-33-001, REV A
MODEL:	ECLIPSE EA500
SUBJECT:	LANDING LIGHT BALLAST LOCATION INSPECTION/REWORK

1. PLANNING INFORMATION

A. Effectivity

Aircraft Serial Numbers 0001-0299.

B. Reason

To increase the life of the landing light and the ballast.

C. Description

This Service Bulletin provides the procedure to inspect and relocate the ballast within the landing light cannister, if necessary.

D. Relevant Publications

None

E. Compliance

Eclipse Aerospace considers this to be a recommended upgrade that can be accomplished at the operator's discretion.

F. Approval

This Service Bulletin is based on engineering data that is FAA-approved, and the modification herein complies with the applicable regulations.

G. Labor Requirements

The following information is for planning purposes only.

(1) Estimated labor hours to perform:

- Suggested number of personnel: 1
- Left and right forward Wing to Body Fairing Removal: 0.75 Hours
- Left and right Landing Light Removal: 0.5 Hours
- Left and right Ballast Relocation/Rework: 1.5 Hours
- Left and right Landing Light Installation (includes sealant and paint touch-up): 3.0 Hours
- Left and right forward Wing to Body Fairing Installation: 0.75 Hours

Total labor hours: 6.5

The above is an estimate based on properly equipped and experienced personnel complying with this Service Bulletin. Actual labor hours may vary depending on workforce experience, concurrent maintenance, discovery of other discrepancies, etc.



SERVICE BULLETIN

- (2) Qualification of personnel:
 - A person properly authorized to perform aircraft maintenance under 14 CFR 43 or equivalent approved by the Civil Aviation Authority having jurisdiction.

H. Weight and Balance Change

None

I. Electrical Load Data Change

None

J. Software Accomplishment Summary

Not applicable

K. References

Aircraft Maintenance Manual (AMM), P/N 06-117751, revision 17 or later.

L. Publications Affected

None

2. MATERIAL INFORMATION

A. Consumables

The following consumables are required for this Service Bulletin.

Material	Specification	Use
Polythioether Sealant	PPG Aerospace (PRC-DeSoto) PR-2001, Type 2, Class B	To fill holes in landing light cannister.

B. Interchangeability/Intermixability of Parts

None

C. Part Re-identification

Remark cannisters "Part Modified per SB 500-33-001" with indelible pen.



SERVICE BULLETIN

3. ACCOMPLISHMENT INSTRUCTIONS

A. Procedure

- (1) Make aircraft safe for maintenance. Refer to AMM 20-00-01 - MAKE SAFE FOR MAINTENANCE.
- (2) Remove 251 CL Left Forward Wing-to-Body Fairing and 252 BR Right Forward Wing-to-Body Fairing. Refer to AMM 53-11-12 FORWARD WING TO BODY FAIRING ASSEMBLY - REMOVAL.
NOTE: Procedure is shown for the left side landing light. Right side landing light is opposite.
- (3) Inspect left and right Landing Light Canister for 1.25 inch (REF) distance from aft ballast mounting hole to the exterior back of canister. Refer to [\(REF\) Detail A, Figure 1](#).
NOTE: The Landing Light Ballast does not need to be removed to measure the REF dimension. Measure from the center of the fastener to the outside edge of the cannister.
 - (a) If hole measurement is 1.25 inches or less on both the right and left sides, install 251 CL Left Forward Wing-to-Body Fairing and 252 BR Right Forward Wing-to-Body Fairing. Refer to AMM 53-11-12 FORWARD WING TO BODY FAIRING ASSEMBLY - INSTALLATION. Proceed to step (10).
 - (b) If hole measurement is greater than 1.25 inches proceed to the next step.



SERVICE BULLETIN

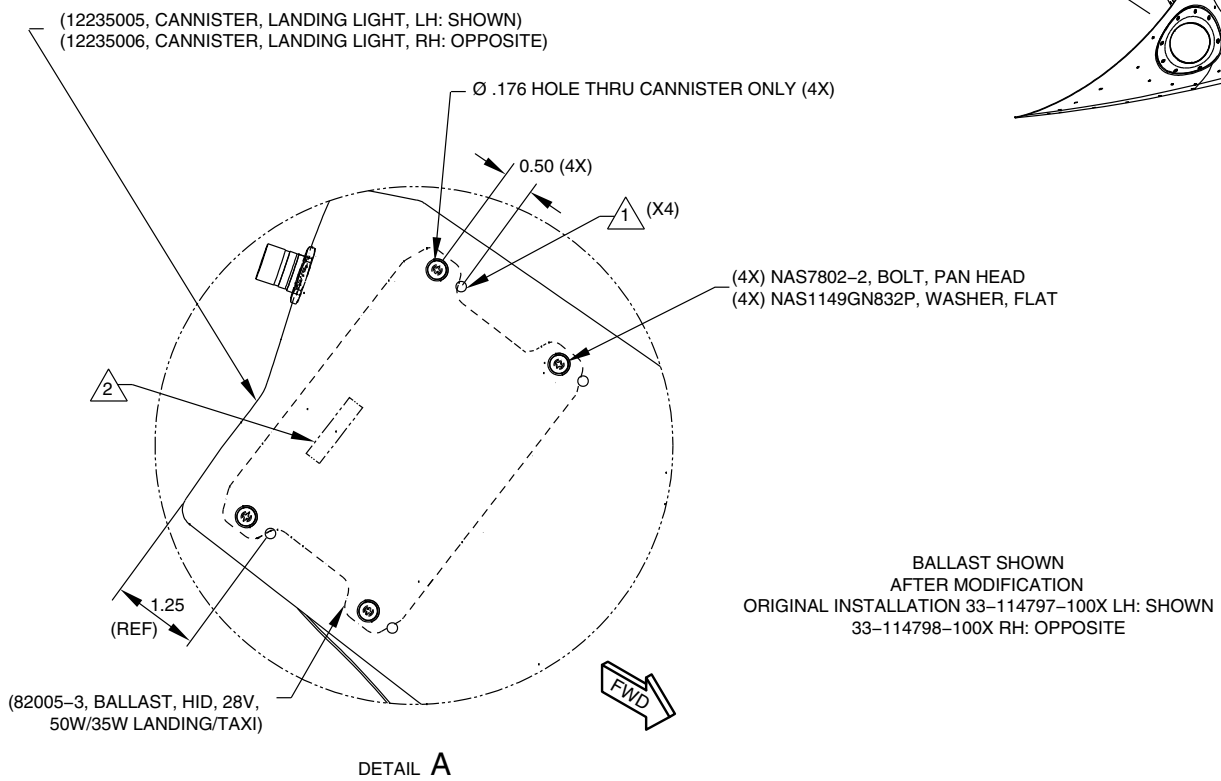
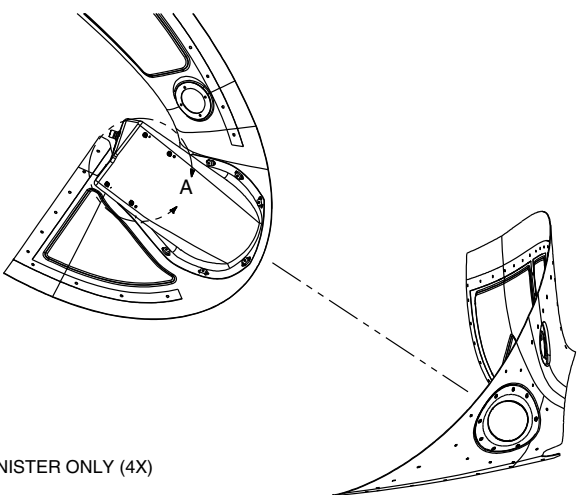

Landing Light Ballast Rework
Figure 1



RECOMMENDED

**ECLIPSE
AEROSPACE**

SERVICE BULLETIN

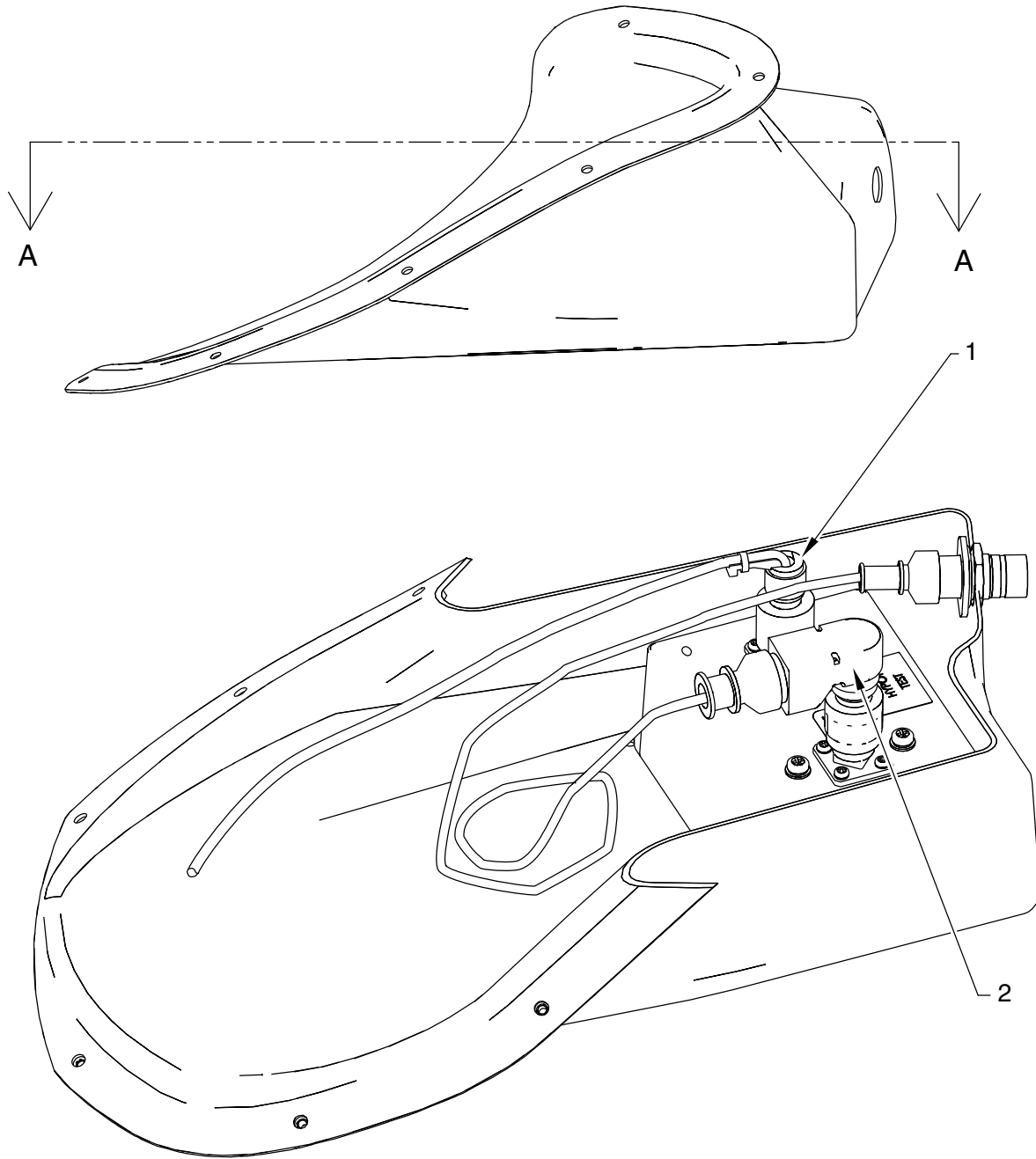

SECTION A – A

**Electrical Connector Backshell Clocking
Figure 2**

5091233A



SERVICE BULLETIN

- (4) Remove affected left and/or right Landing Light Ballast. Refer to AMM 33-40-19 BALLAST, LANDING LIGHT - REMOVAL.
- (5) Locate and drill four 0.176 diameter holes into landing light cannister. Refer to [Figure 1](#).
- (6) Fill original holes (X4) ([Flag Note 1](#), [Figure 1](#)) with PPG Aerospace (PRC-DeSoto) PR-2001, Type 2, Class B sealant. Build up sealant a minimum of 0.05 inch above the surface of the cannister on both sides. Sealant must extend beyond the edge of hole onto the cannister surface a minimum of 0.03 inch.
NOTE: Allow sealant to cure before installing the ballast.
- (7) Mark cannister with indelible ink at location ([Flag Note 2](#), [Figure 1](#)) "Part Modified per SB 500-33-001".
- (8) Re-clock electrical connector backshells ([1 and 2](#), [Figure 2](#)) as shown for both left and right sides.
- (9) Install left and right Landing Light Ballasts, rotate left and right Landing Light Ballast 180 degrees from original position. Refer to AMM 33-40-19 Refer to AMM 33-40-19 BALLAST, LANDING LIGHT INSTALLATION and [Figure 2](#).
- (10) Do Adjustment/Test on left and right Landing Lights. Refer to AMM 33-00-00 LIGHTS, ADJUSTMENT/TEST.
- (11) If no further maintenance is required, return the aircraft back to service. Refer to AMM - 20-00-02-051-801 - RETURN TO SERVICE (AFTER MAINTENANCE).

B. Limitations and Procedures

None

C. Cost

Contact Eclipse Aerospace Customer Care for cost and availability.

4. RECORD OF COMPLIANCE

Upon completion of this Service Bulletin, make an appropriate maintenance-record entry specifying the Service Bulletin number.

5. NOTIFYING ECLIPSE AEROSPACE

On completing this service bulletin, the operator/maintainer shall complete the attached Compliance Record and send it to Eclipse Aerospace via regular mail, fax, or e-mail.

MAILING ADDRESS	Eclipse Aerospace Incorporated ATTN: Customer Care 2503 Clark Carr Loop SE Albuquerque, NM 87106
Fax	1-505-241-8802
E-mail	customer care@eclipseaerospace.net

